

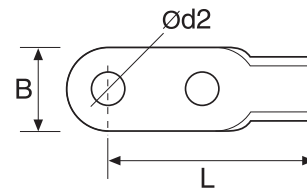



Terminales tubulares especiales doble taladro



Material: Cobre
Acabado: Estañado

Ref.	Sección cable mm ² / AWG / MCM	Dimensiones mm.				Ref.	Sección cable mm ² / AWG / MCM	Dimensiones mm.			
		Ød2	B	L				Ød2	B	L	
RD-38-10	38	11,0	22,0	84,0	50/250	RD-150-12	150	14,0	36,0	105,5	10/50
RD-38-12	26,66-42,42	14,0	22,0	84,0	50/250	RD-150-14	117,2-152,05	16,0	36,0	105,5	10/50
	2						250-300				
RD-60-10	60	11,0	22,0	81,0	25/200	RD-180-12	180	14,0	38,5	111,0	5/25
RD-60-12	42,42-60,57	14,0	22,0	89,0	25/200	RD-180-14	152,05-192,6	16,0	38,5	111,0	5/25
RD-60-14	1/0	16,0	32,0	97,0	25/200		350				
RD-70-10	70	11,0	24,0	83,0	25/200	RD-200-12	200	14,0	44,0	117,0	5/15
RD-70-12	60,57-76,28	14,0	24,0	91,0	25/200	RD-200-14	192,6-242,27	16,0	44,0	117,0	5/15
RD-70-14	2/0	16,0	32,0	97,0	25/200		400				
RD-80-10	80	11,0	27,0	86,0	25/100	RD-325-12	325	14,0	50,5	124,0	5/10
RD-80-12	76,28-96,3	14,0	27,0	94,0	25/100	RD-325-14	242,27-325,0	16,0	50,5	124,0	5/10
RD-80-14	3/0	16,0	32,0	99,0	25/100		500-600				
RD-100-10	100	11,0	28,5	87,0	25/50						
RD-100-12	96,3-117,2	14,0	28,5	95,0	25/50						
RD-100-14	4/0	16,0	32,0	99,0	25/50						